

VISOR™ FABRICATION

FACE MOUNT APPLICATION

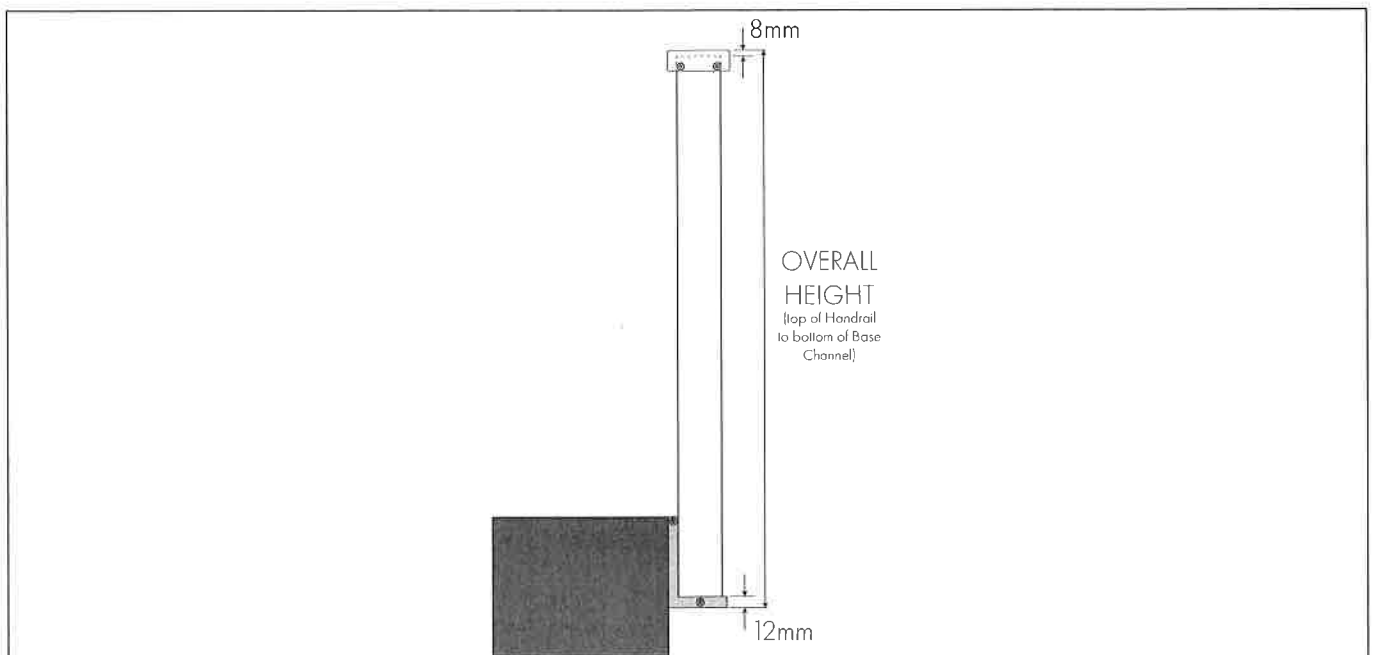
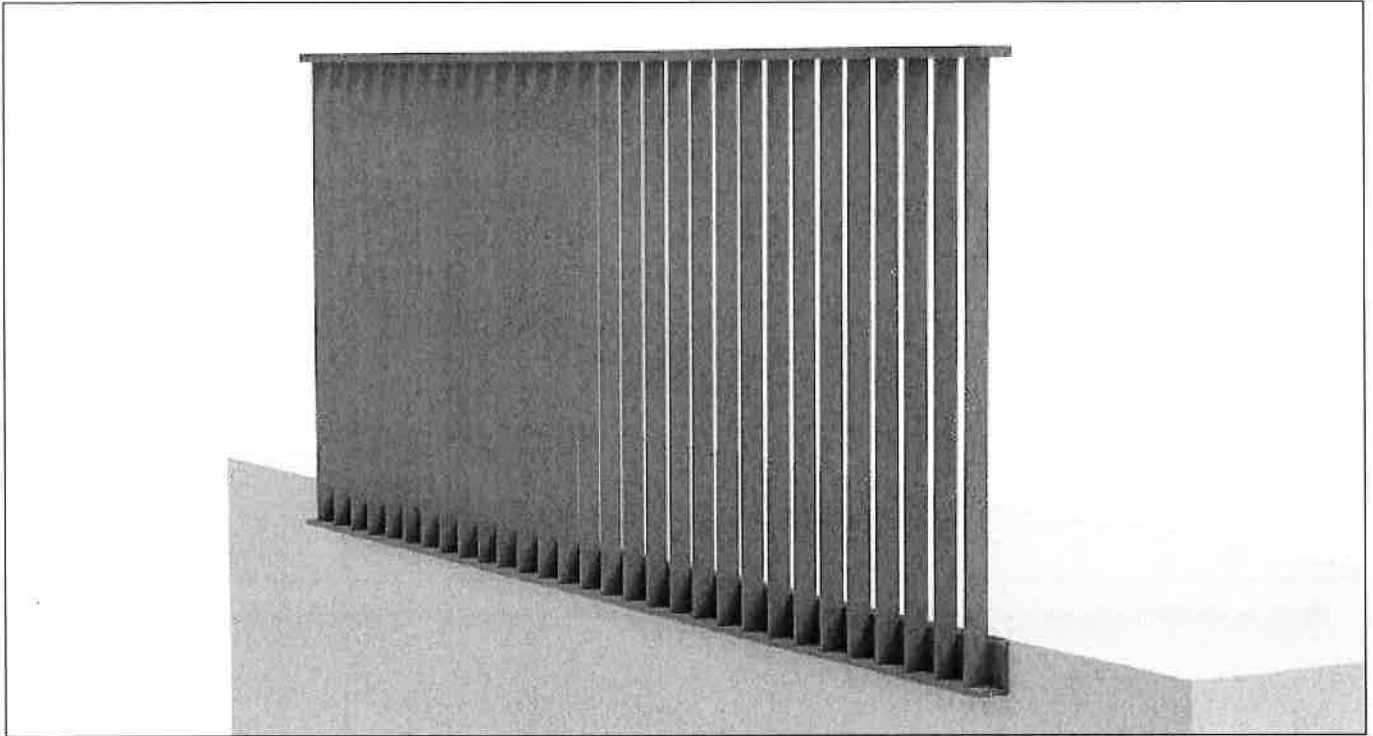

- 1 Cut Balusters to the required length, noting the Baluster height on the Face Mount Base and protrusion into the Handrail.
Baluster Height = Overall height - 20mm

VISOR™ FABRICATION

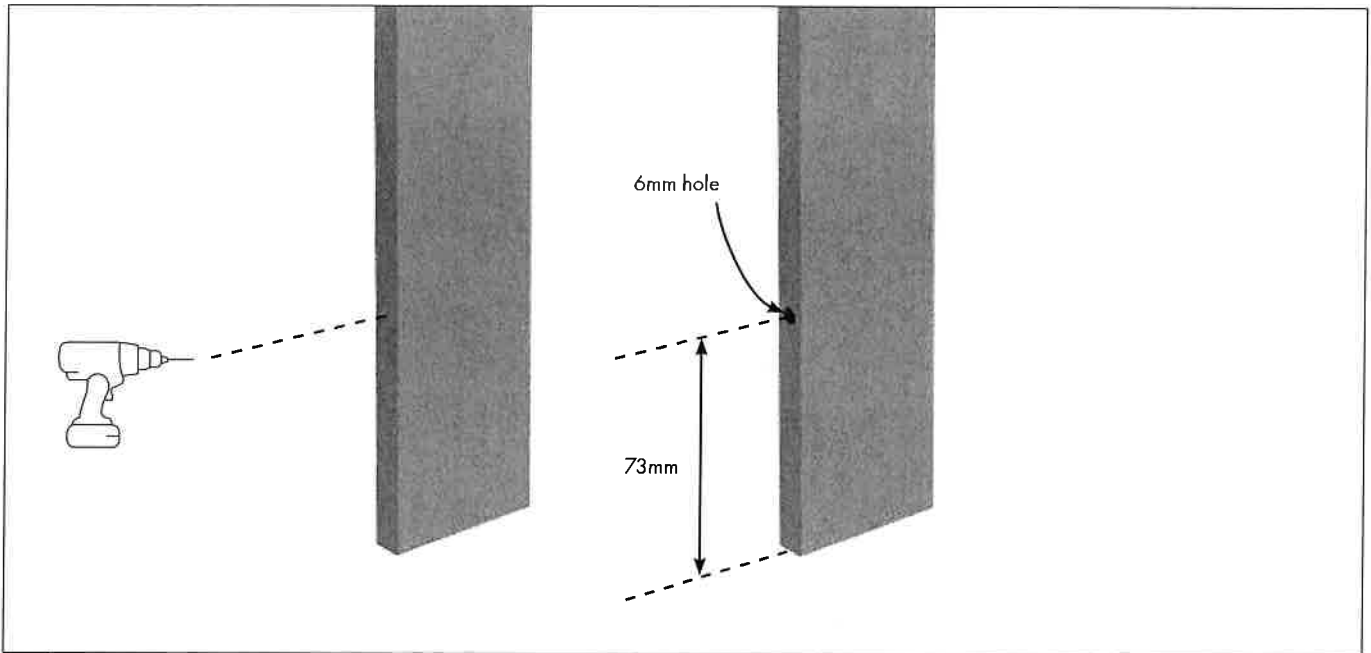

- 2 At one end (only) of the 50mm x 10mm Baluster, drill 1 x 6mm hole centrally on the 10mm face of the Baluster, 73mm from the end.

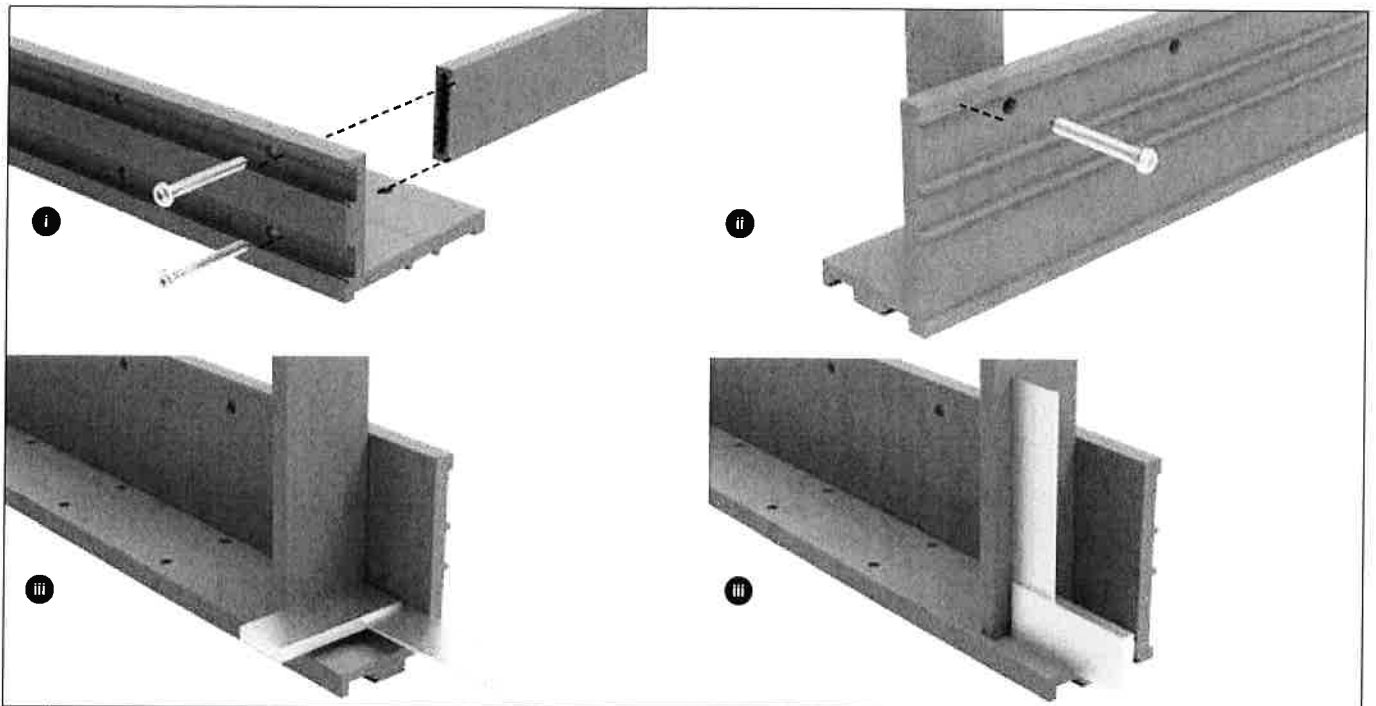

- 3 After cutting the Face Mount Base to the required length (see Appendix 3 for mitred corners), on a flat, padded surface;
- Affix each Baluster using 2x 12G x 50mm panhead screws to the underside of the pre-drilled Face Mount Base.
 - Affix each Baluster with 1x 14G x 50mm panhead screw to the side of the pre-drilled Face Mount Base.
 - Ensure each Baluster is square in the base before a final tighten of screws.

NOTE: A light lubricant is recommended when affixing screws.

VISOR™ FABRICATION

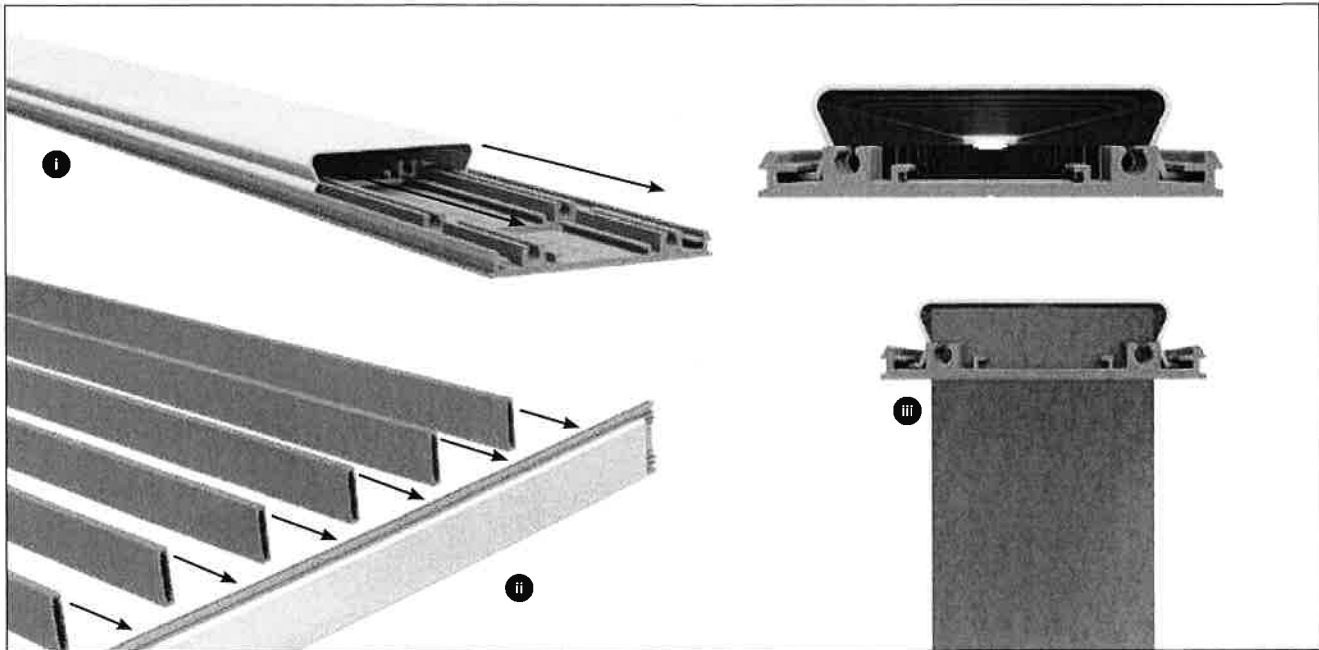

- 4 Once all Balusters are affixed square on the Face Mount Base, cut the Undercapping Plate and Friction Insert to suit the Face Mount Base length and Baluster spacings (see Appendix 1 for Handrail termination considerations);
- i. Slide the Friction Insert into the Undercapping Plate.
 - ii. While the panel is lying flat, tap the slotted Undercapping Plate into the top of the Balusters.
 - iii. Ensure all Balusters touch the inner face of the Friction Insert.

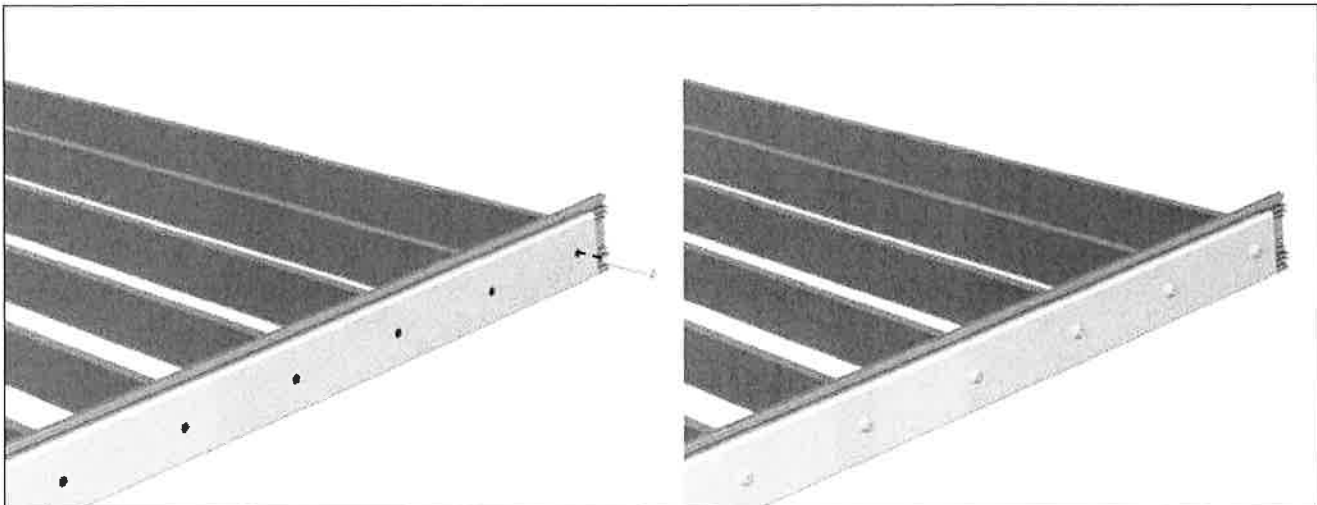

- 5 Drill a 6mm hole to the top v-groove of the Friction Insert, aligning to the centre of each Baluster.
Affix 1x 14G x 50mm Panhead Screw to the top of each Baluster.

VISOR™ FABRICATION

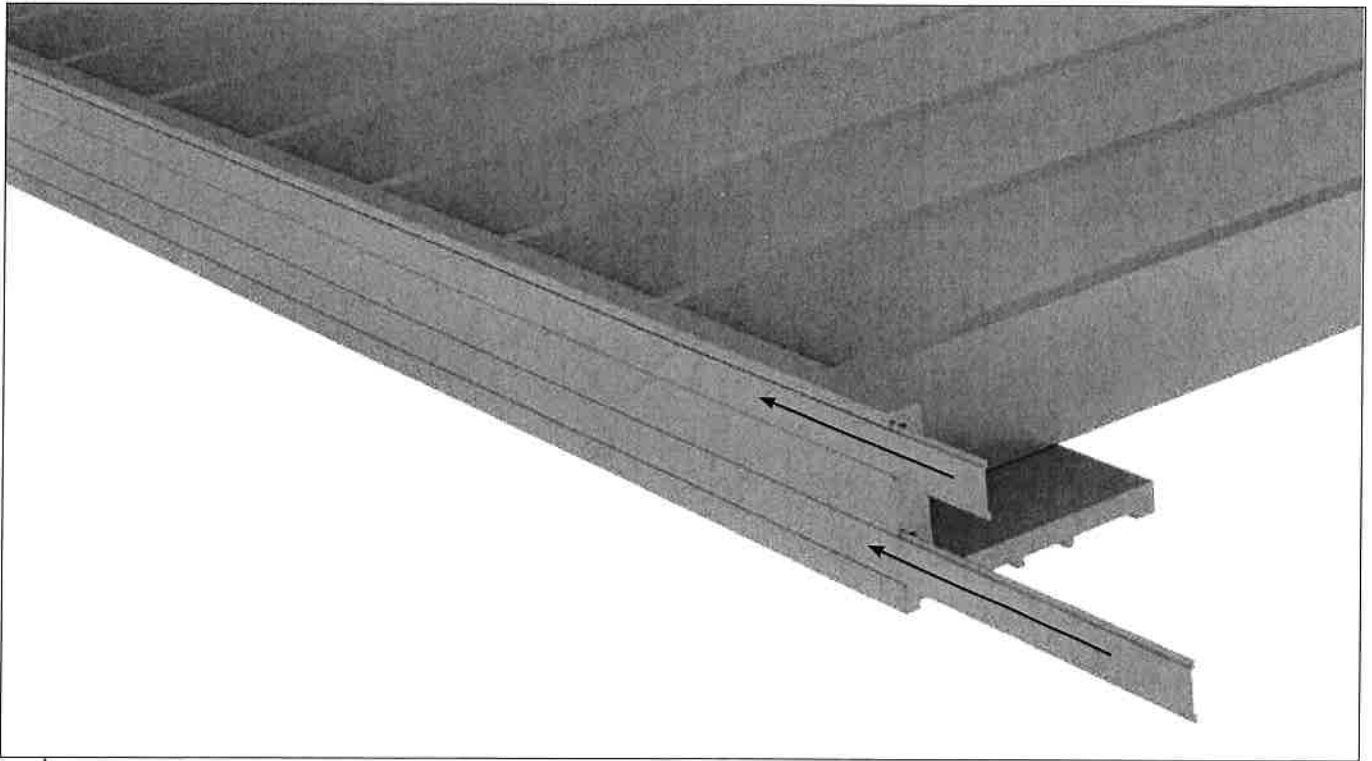

- 6 Cut the two Face Mount Base bottom covers to suit the length of the base and slide both into the bottom recesses to conceal the screw fixings.

NOTE: The ends of the bottom covers may need to be trimmed or filed to ensure smooth insertion into the Face Mount Base recesses.

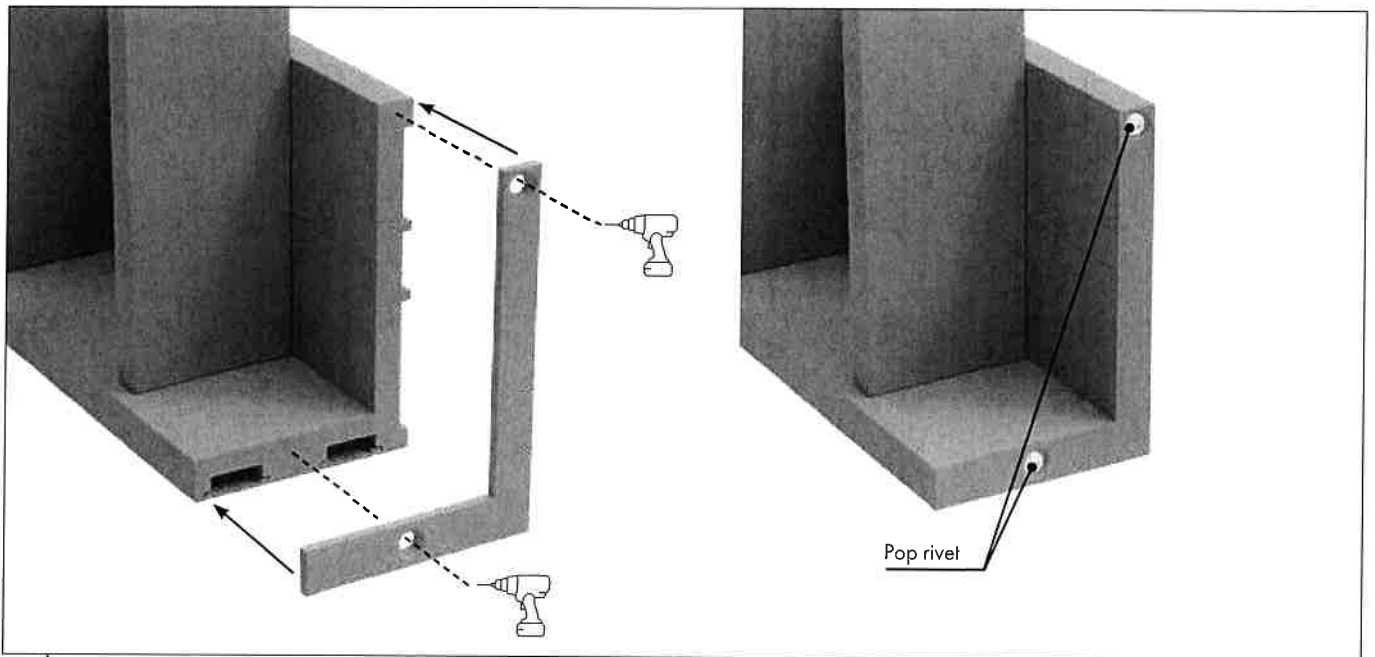

- 7 Attached the Face Mount End Plates to any exposed base profile end by drilling a 3.5mm hole and affixing with a colour matched 3.2mm Dia. aluminium pop rivet (not supplied).

VISOR™ FABRICATION

AFTER FABRICATED PANEL INSTALLATION

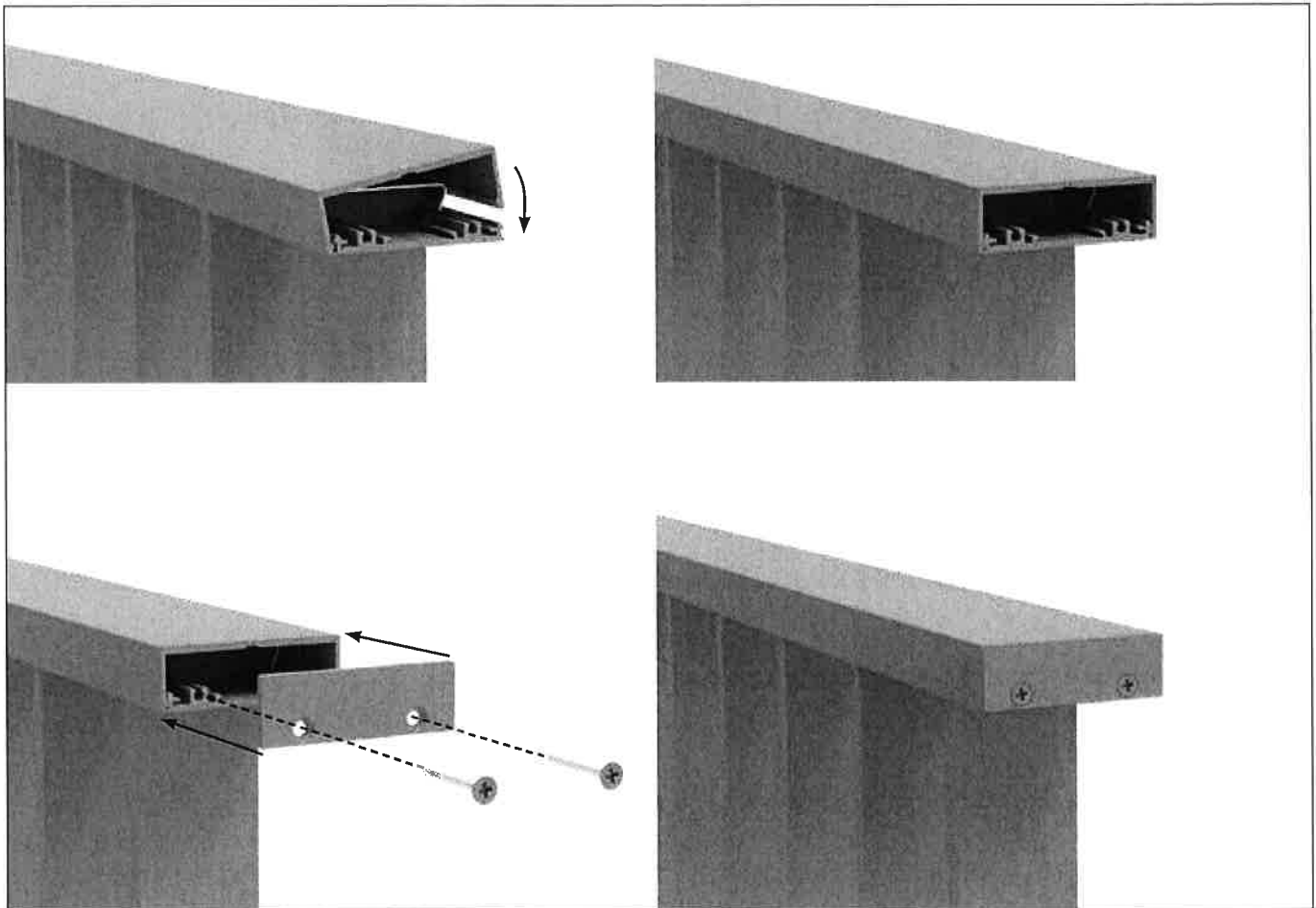

- 8 Affix all Handrails, Handrail Joiners, Handrail End Plates, or Handrail Offset Brackets after the installation of the fabricated panel (see Appendix 1 and 2). Example of End Plate shown above.

NOTE: Ensure the outer Handrail spans any inline joints in the Handrail Undercapping and Friction Insert.

VISOR™ FABRICATION

DECK MOUNT APPLICATION

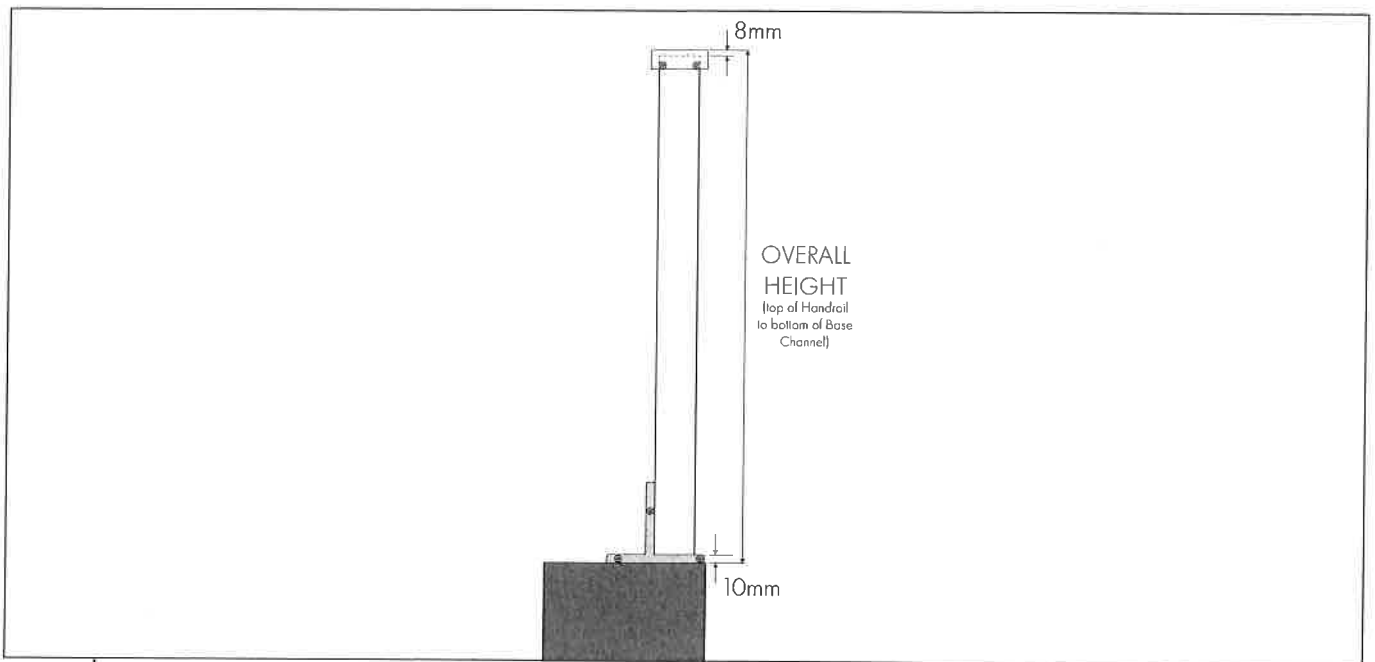
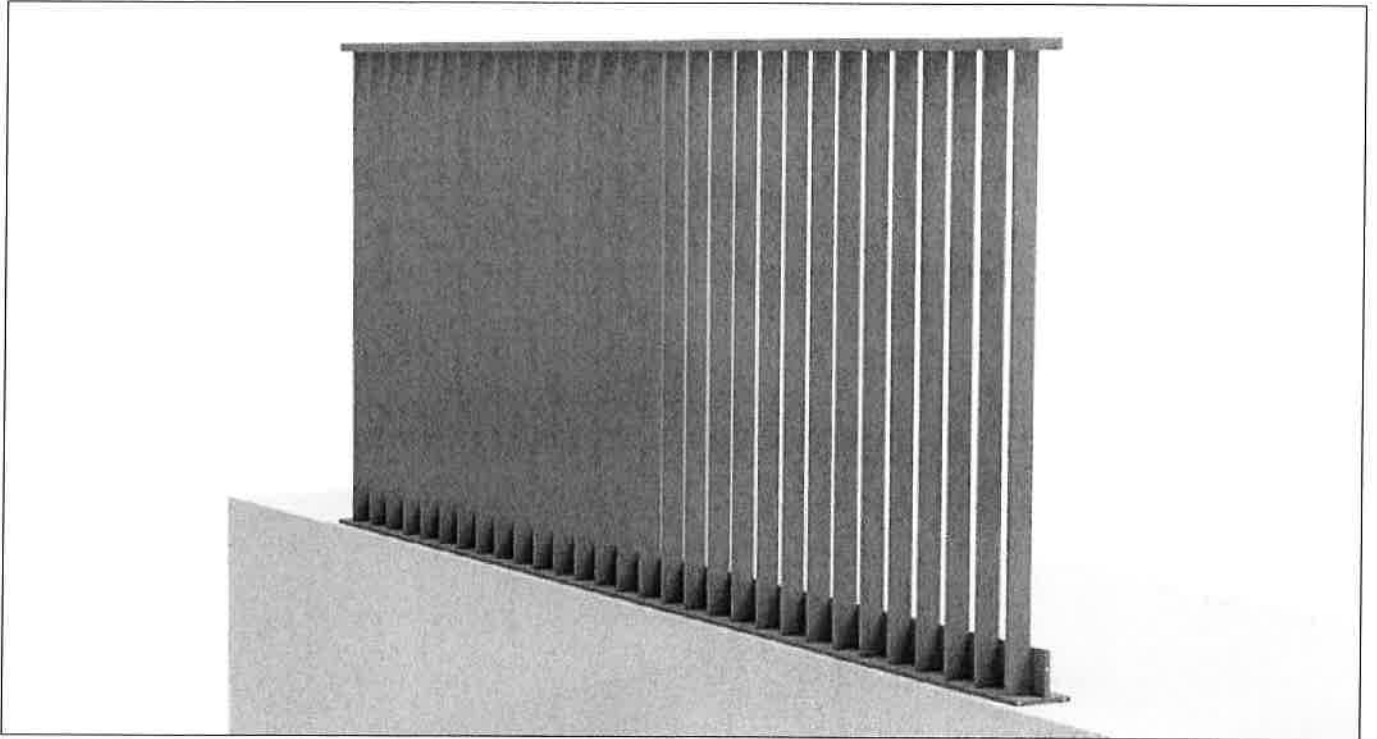

- A** Cut Balusters to the required length, noting the Baluster height on the Deck Mount Base and protrusion into the Handrail.
Baluster Height = Overall height – 18mm

VISOR™ FABRICATION

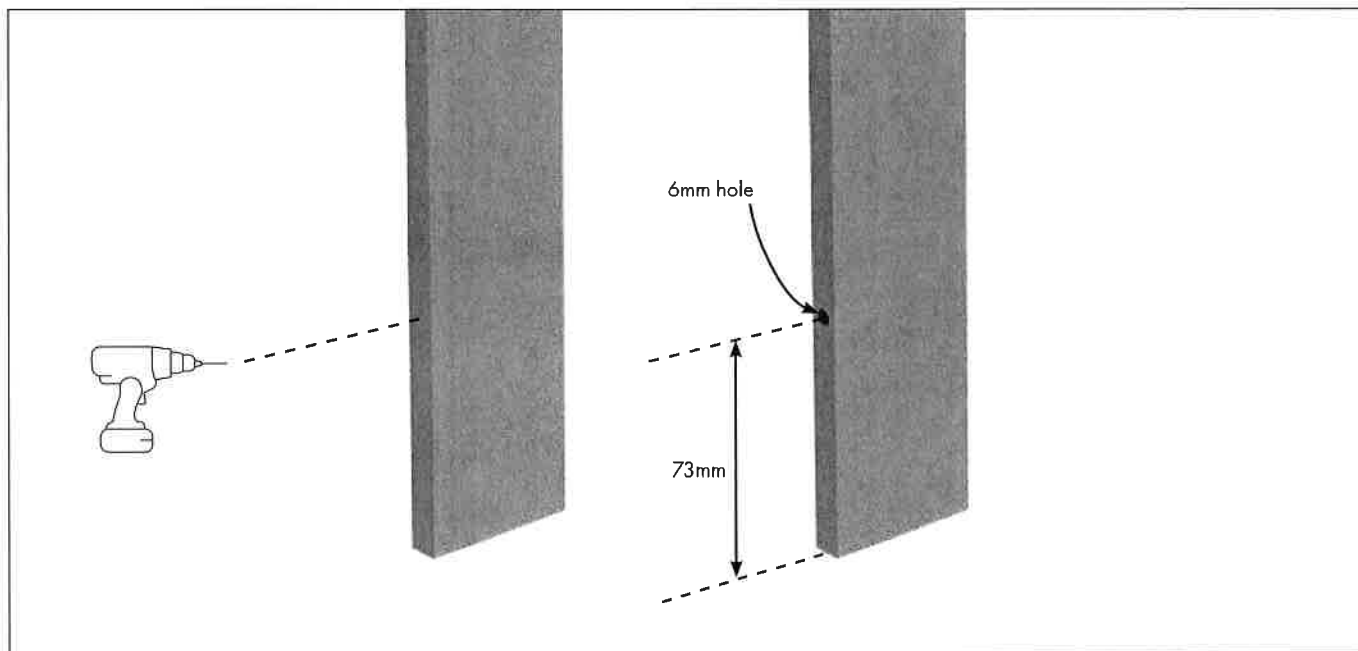

- B** At one end (only) of the 50mm x 10mm Baluster, drill 1 x 6mm hole centrally on the 10mm face of the Baluster, 73mm from the end.

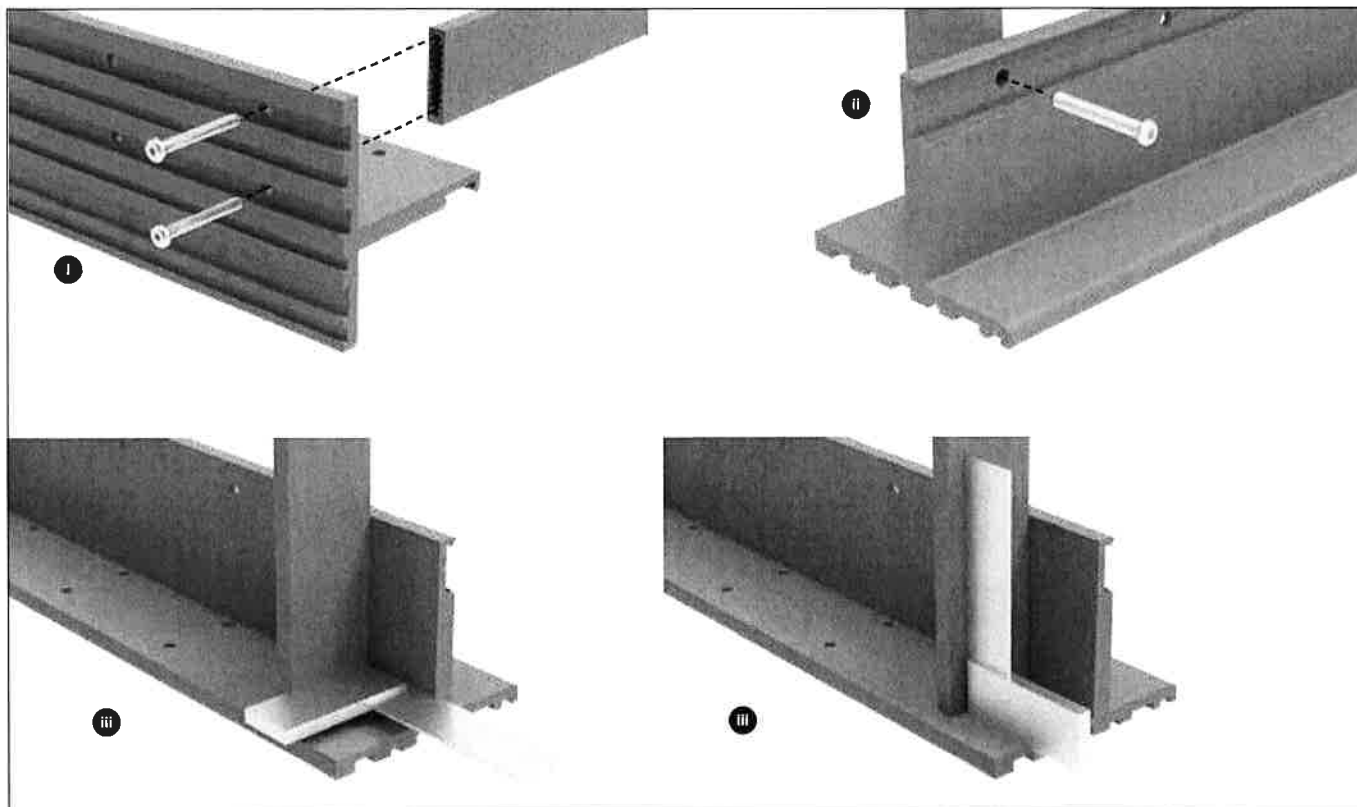

- C** After cutting the Deck Mount Base to the required length (see Appendix 4 for mitred corners, and Appendix 5 for drainage considerations), on a flat, padded surface;
- i. Affix each Baluster using 2x 12G x 50mm panhead screws to the underside of the pre-drilled Deck Mount Base.
 - ii. Affix each Baluster with 1x 14G x 50mm panhead screw to the side of the pre-drilled Deck Mount Base.
 - iii. Ensure each Baluster is square in the base before a final tighten of screws.

NOTE: A light lubricant is recommended when affixing screws.

VISOR™ FABRICATION

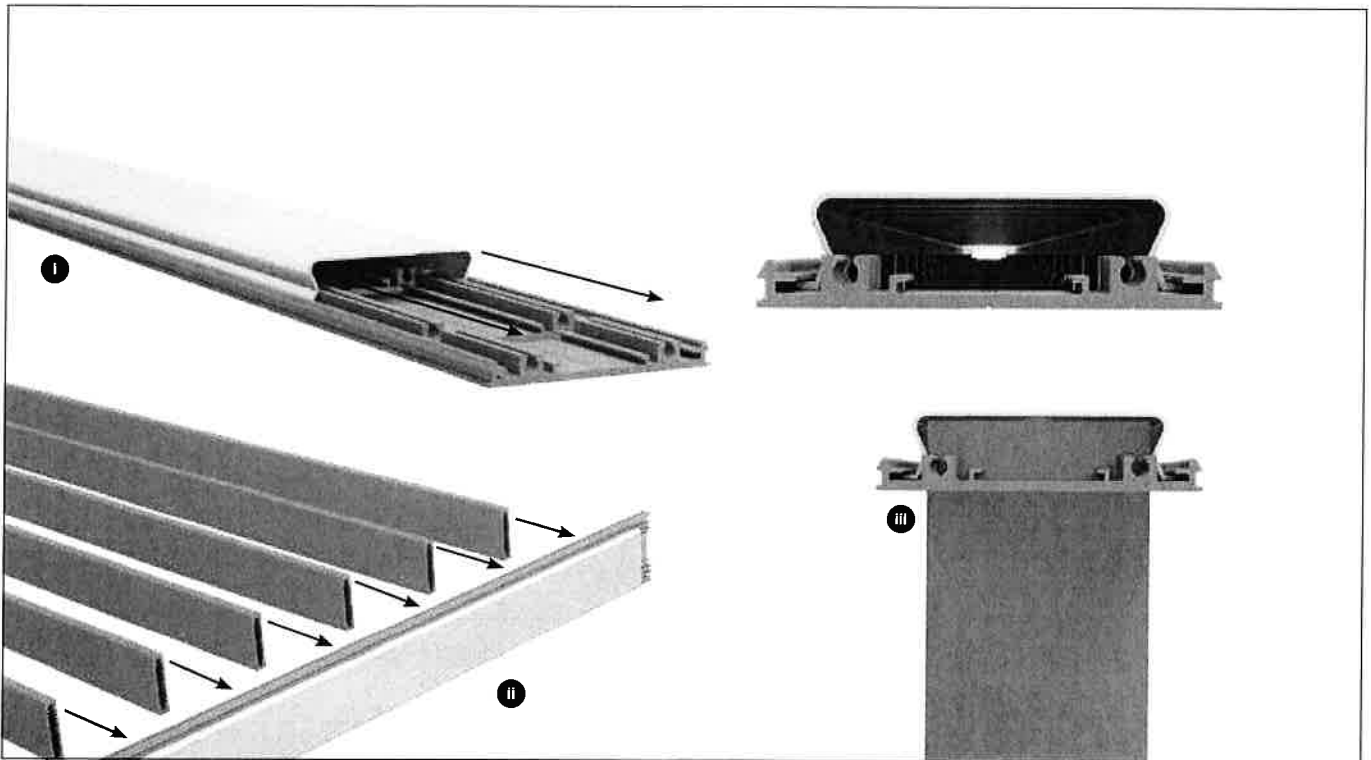

- D** Once all Balusters are affixed square on the Deck Mount Base, cut the Undercapping Plate and Friction Insert to suit the Deck Mount Base length and Baluster spacings (see Appendix 1 for Handrail termination considerations);
- Slide the Friction Insert into the Undercapping Plate.
 - While the panel is lying flat, tap the slotted Undercapping Plate into the top of the Balusters.
 - Ensure all Balusters touch the inner face of the Friction Insert.

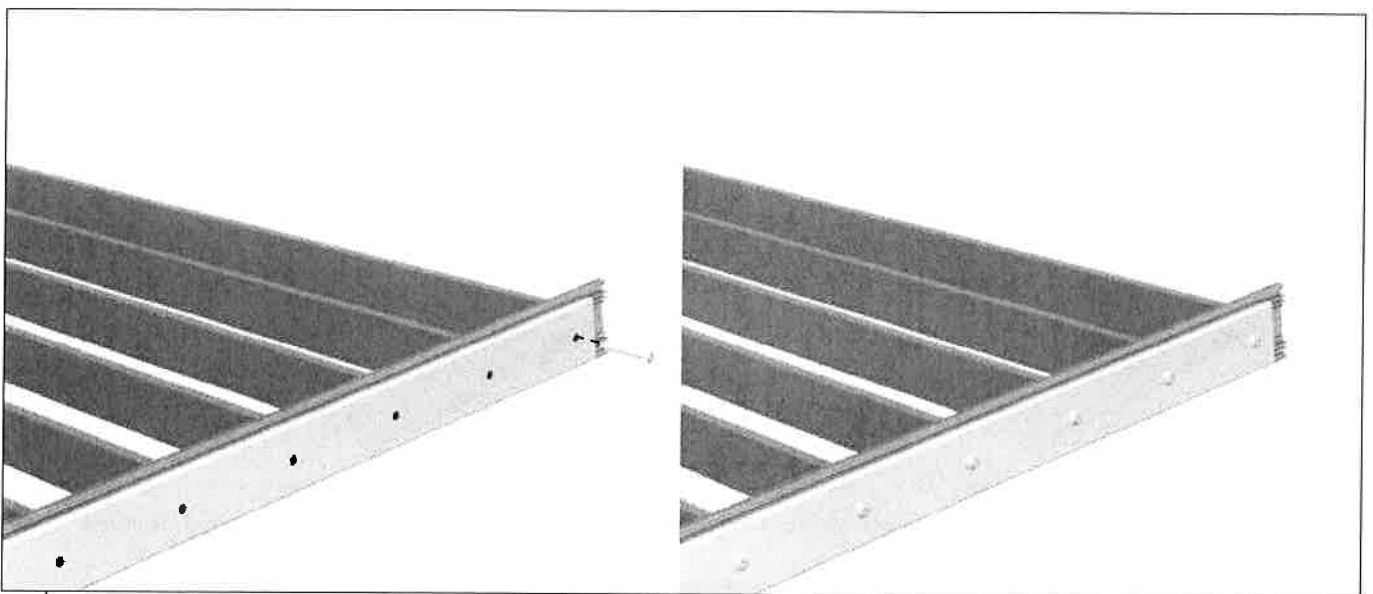

- E** Drill a 6mm hole to the top v-groove of the Friction Insert, aligning to the centre of each Baluster.
Affix 1x 14G x 50mm Panhead Screw to the top of each Baluster.

VISOR™ FABRICATION

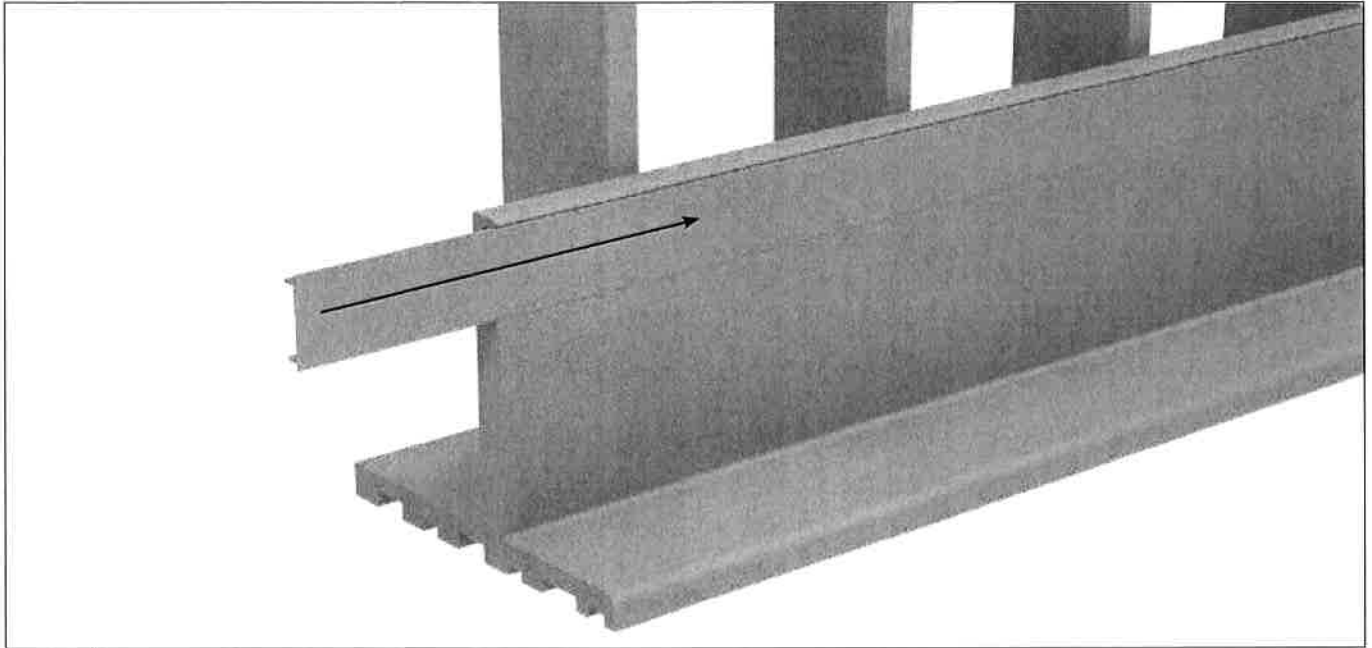

- F** Cut the Deck Mount Base side cover to suit the length of the base and slide into the side recess to conceal the screw fixings.

NOTE: The end of the side covers may need to be trimmed or filed to ensure smooth insertion into the Deck Mount Base recess.

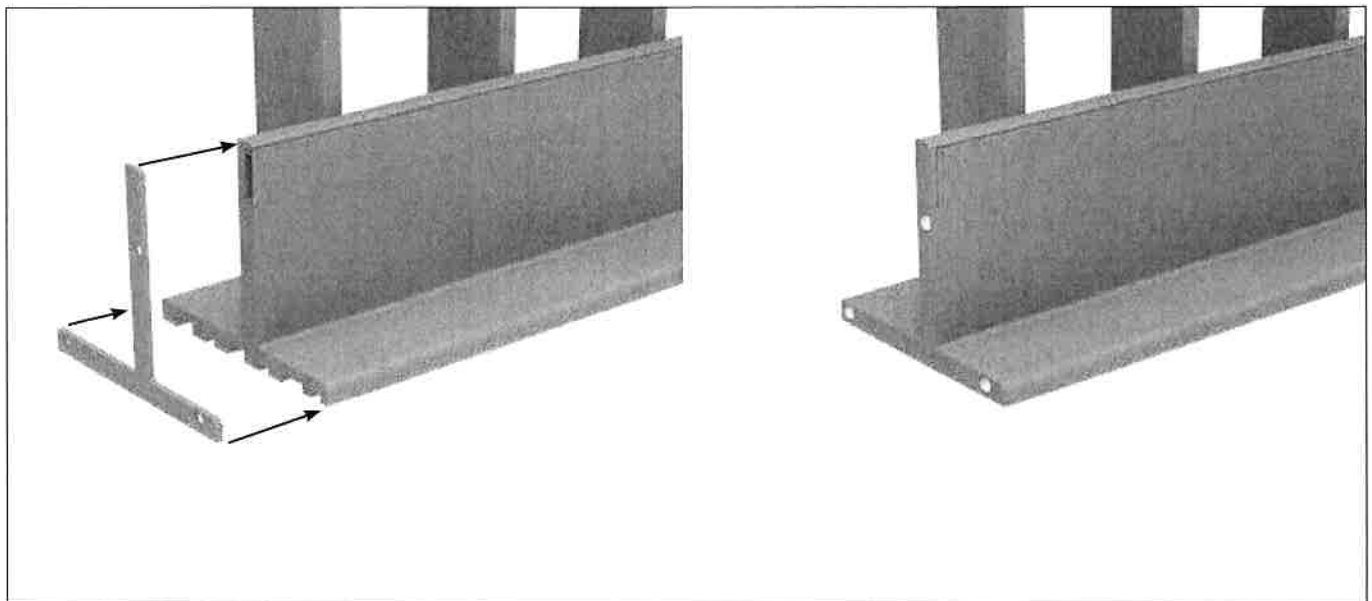

- G** Attach the Deck Mount End Plates to any exposed base profile end by drilling a 3.5mm hole and affixing with a colour matched 3.2mm Dia. aluminium pop rivet (not supplied).

VISOR™ FABRICATION

AFTER FABRICATED PANEL INSTALLATION

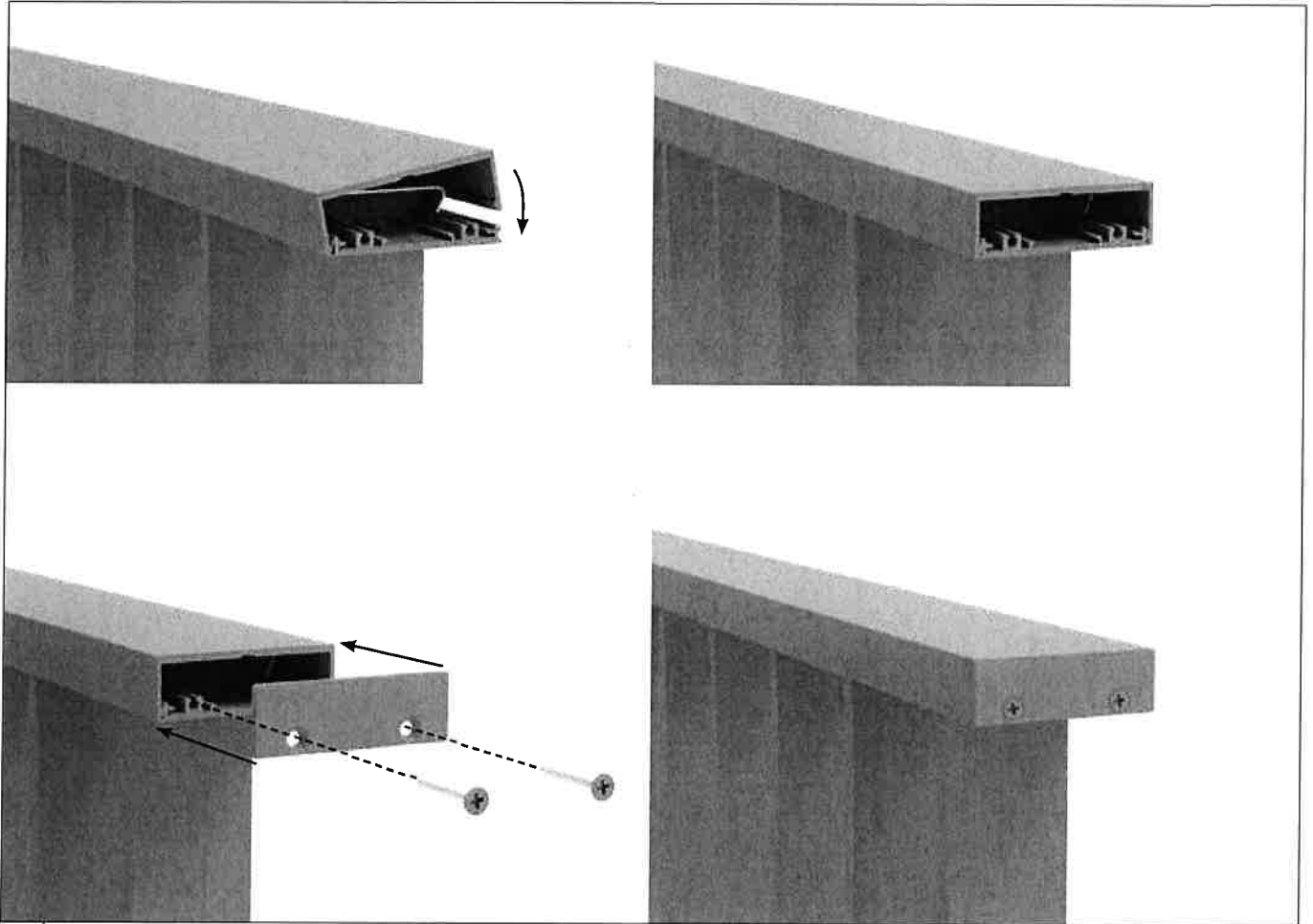

H Affix all Handrails, Handrail Joiners, Handrail End Plates, or Handrail Offset Brackets after the installation of the fabricated panel.
Example of End Plate shown above.

NOTE: Ensure the outer Handrail spans any inline joins in the Handrail Undercapping and Friction Insert.

VISOR™ FABRICATION – APPENDIX 1

HANDRAIL TERMINATION

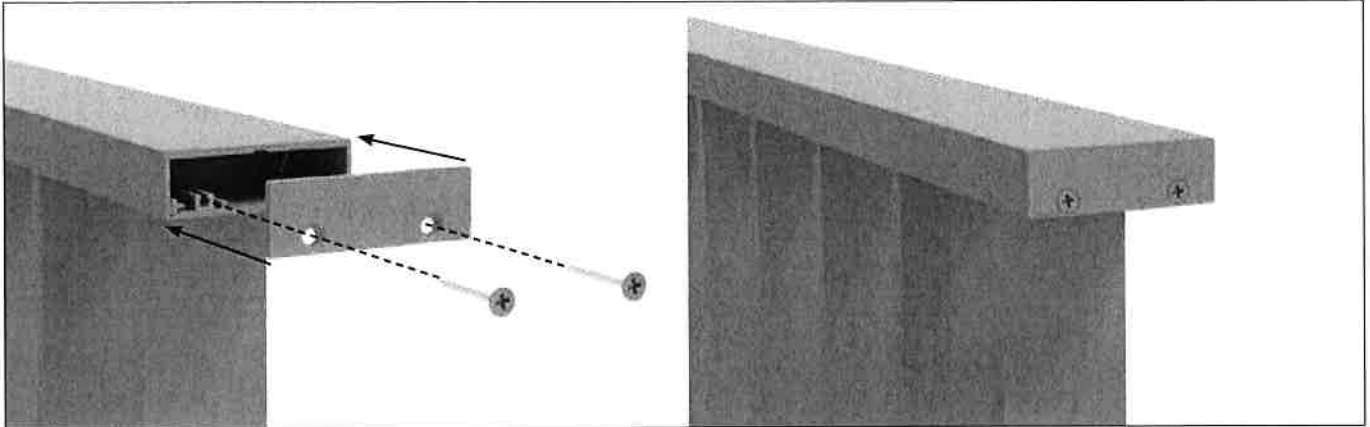

Option 1: Handrail End Plate

For Handrails that do not terminate at an existing post or wall, simply screw a Handrail End Cap to the screw flutes in the Undercapping Plate using two 8G x 25mm Countersunk Screws.

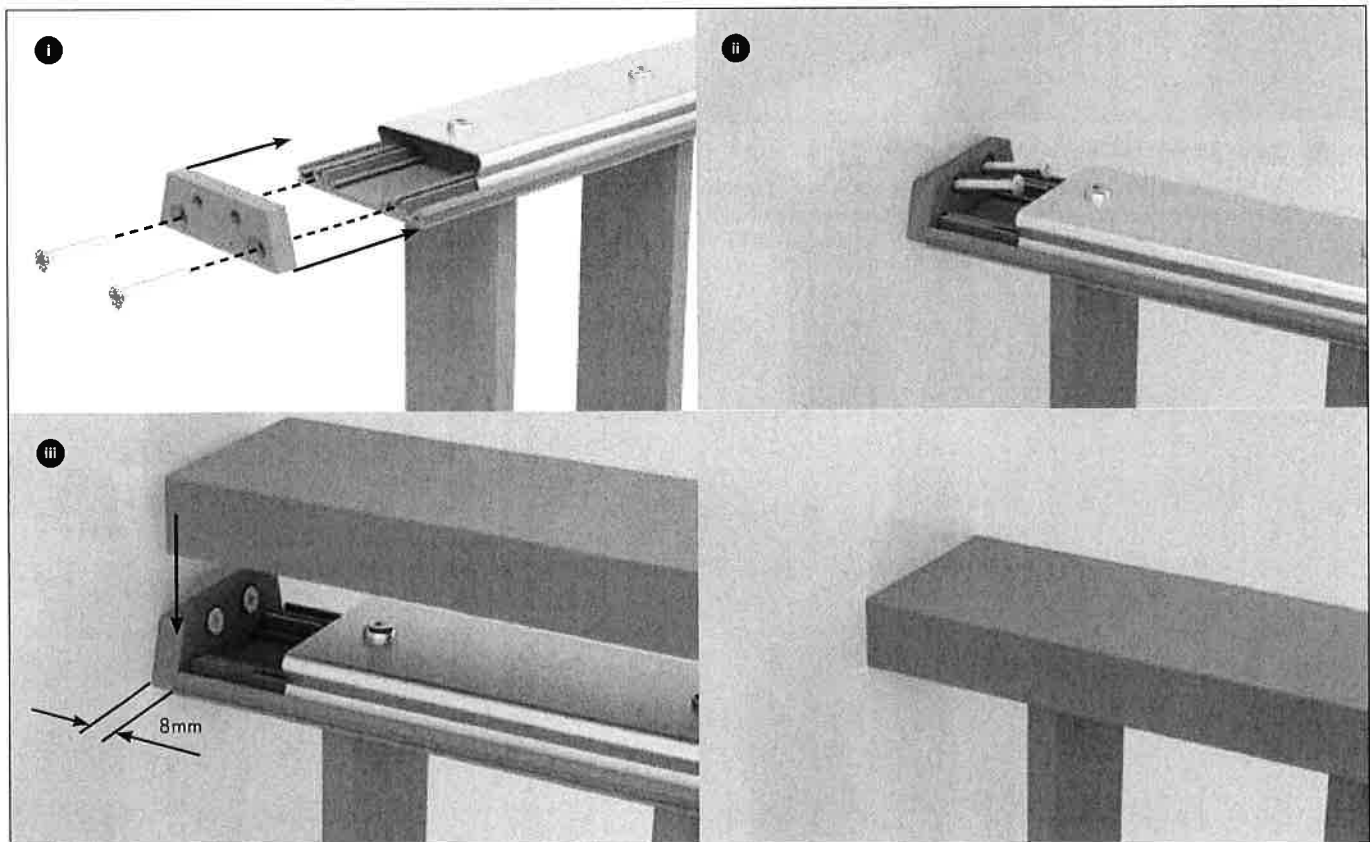

Option 2: Handrail Wall Bracket

For Handrails that terminate directly to an existing post or wall, ensure the Undercapping and Friction Insert is cut 8mm shorter and affix the Handrail Wall Bracket to the screw flutes in the Undercapping Plate using two 8G x 25mm Countersunk Screws.

Affix the bracket to the existing wall or post using an appropriate fixture for the substrate (noting the Friction Insert will need to be notched/trimmed for screw access).

Snap-fix the Handrail over the Handrail Wall Bracket at full length to conceal the fixings.

VISOR™ FABRICATION – APPENDIX 1

HANDRAIL TERMINATION

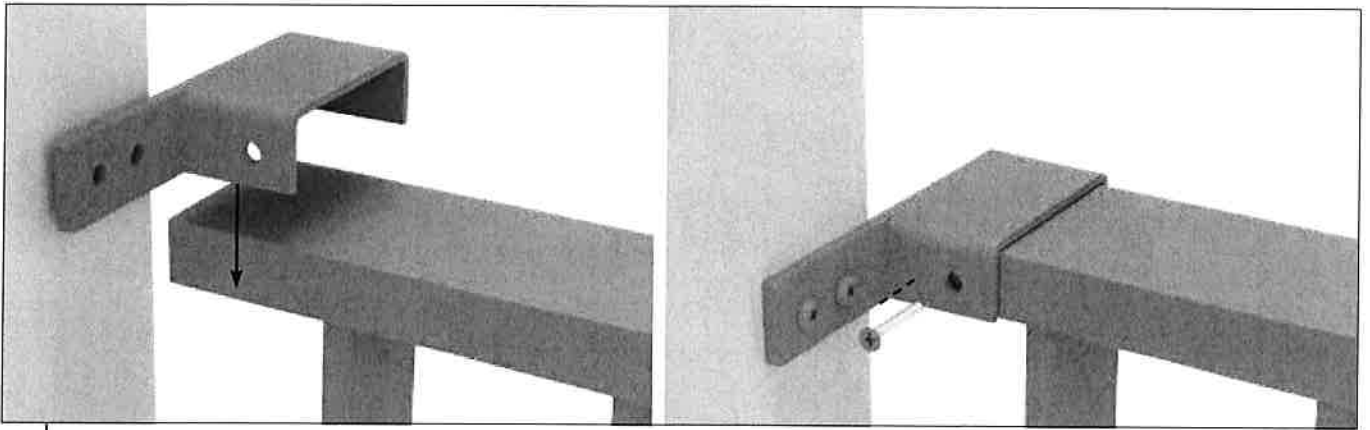

● Option 3: Handrail Offset Brackets

For Handrails that terminate offset to an existing post or wall (particularly when using a Face Mount Base), cut the Handrail, Friction Insert and Undercapping Plate 6mm shorter at each location that a Handrail Offset Bracket is to be used. Affix to the existing post or wall using an appropriate fixture for the substrate. Using an 8G x 25mm countersunk screw, attach the Handrail Offset Bracket to the Handrail and Friction insert.

VISOR™ FABRICATION – APPENDIX 2

HANDRAIL JOINERS

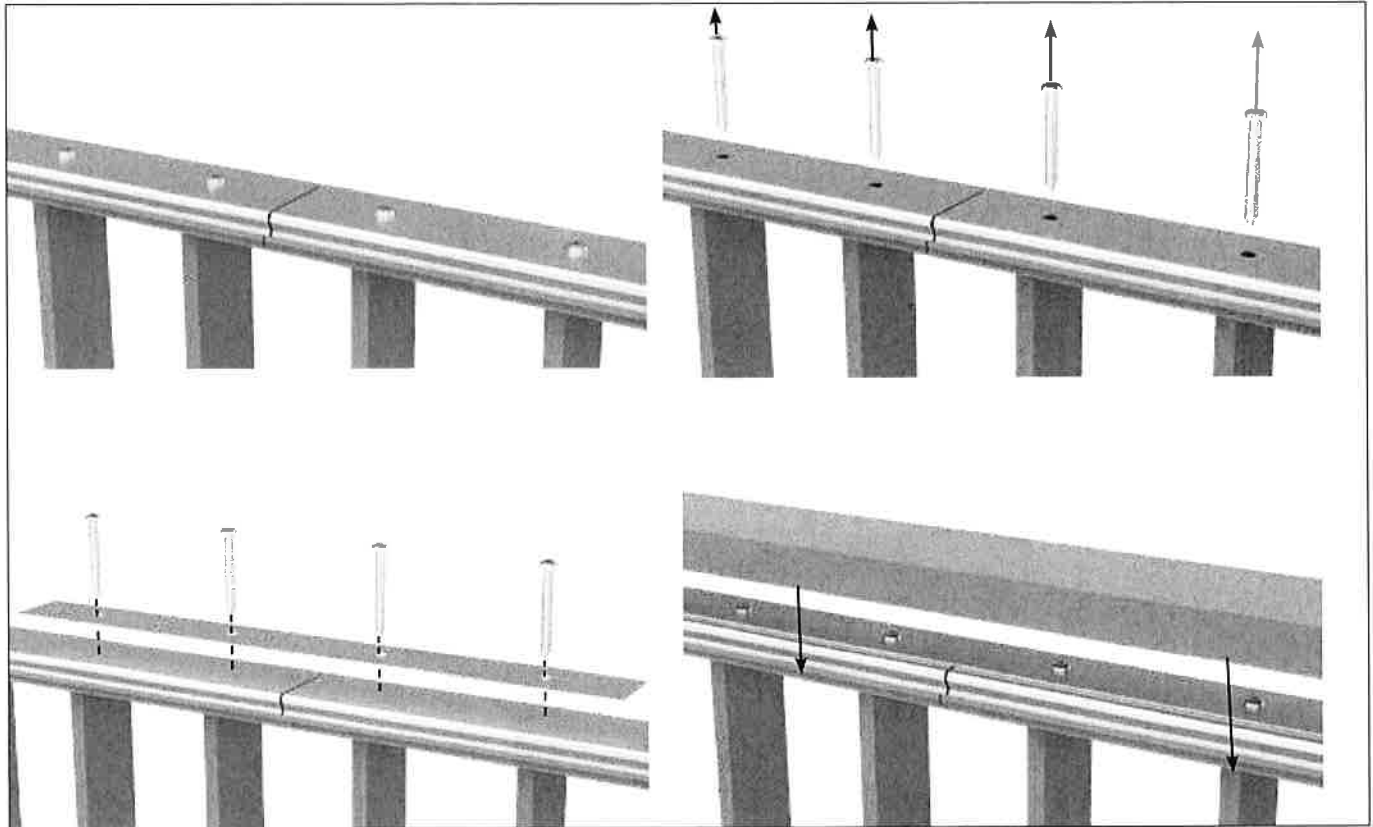

Option 1: Inline Handrail Joiner

Inline Handrail Joiners are added after the installation of the Visor™ balustrade panels and prior to snap-fixing the Handrail into position. Inline Joiners are to be used when joining two Undercapping Plates together. Remove the four 14G x 50mm Panhead Screws from the top of adjacent panels (two from each panel) and affix the Inline Handrail Joiner using the same screws. 7mm holes may need to be drilled if the end Baluster spacings have been altered from original lengths.

Ensure the Handrail spans the join location of the Inline Handrail Joiner to offer further rigidity.

NOTE: The Face Mount Base and the Deck Mount Base do not require a joiner. Simply position the extrusions together end-to-end and affix to the substrate using appropriate fixtures.

VISOR™ FABRICATION – APPENDIX 2

HANDRAIL JOINERS

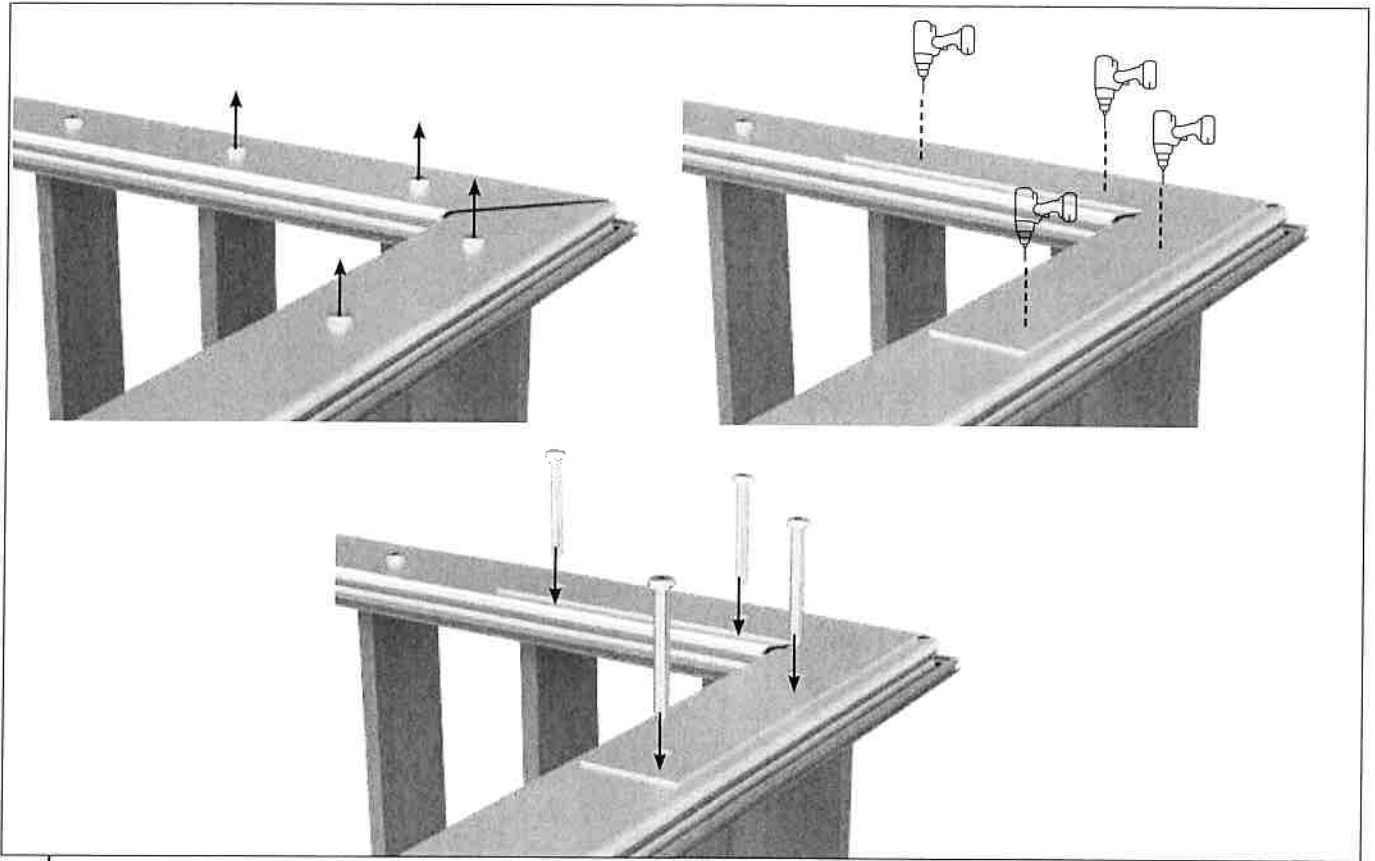

Option 2: 90 Degree Handrail Joiner

A 90 Degree Handrail Joiner is added after the installation of the Visor™ balustrade panels and prior to snap-fixing the Handrail into position. Remove the four 14G x 50mm Panhead Screws from the top of the mitred adjacent panels (two from each panel). Drill 4x 7mm holes to the 90 Degree Handrail Joiner in line with the existing screw holes. Reapply screws to engage the Baluster through the Friction Insert and 90 Degree Joiner.

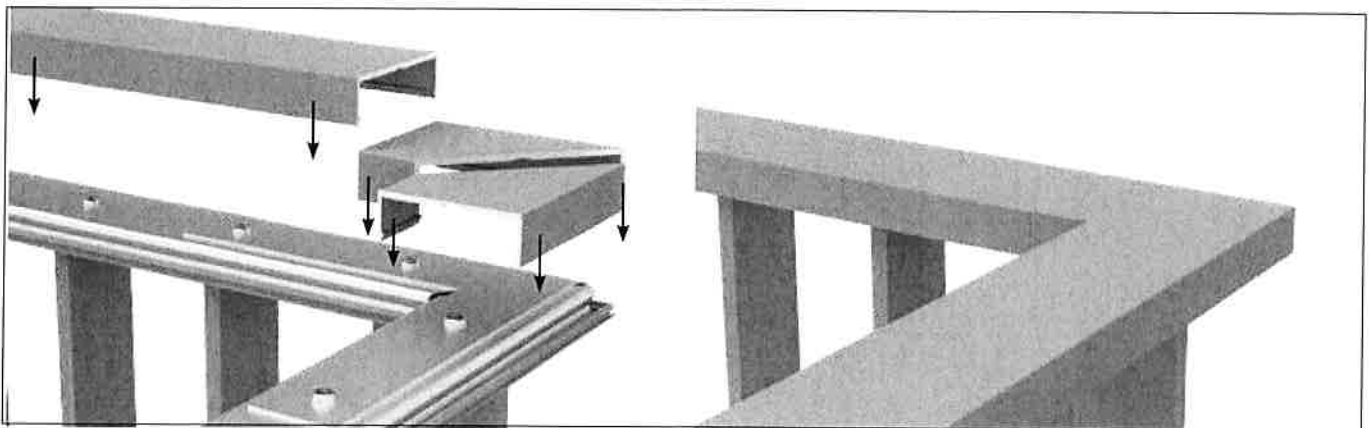

Cut the handrail at a mitre to suit the Undercapping, and cut the other end central to the first Baluster giving two short corner handrail sections. Affix both mitred Handrail sections by clipping/sliding into position. Measure, cut and affix the remaining Handrail with straight cuts.

NOTE: The Face Mount Base and the Deck Mount Base do not require a joiner. Simply position the extrusions together end-to-end and affix to the substrate using appropriate fixtures (see Appendix 3 and 4).

VISOR™ FABRICATION – APPENDIX 3

FACE MOUNT BASE MITRED CORNERS

	Baluster Spacing	Cut Length
MIN	20mm	7mm
MAX	60mm	35mm

**CONTACT US FOR OUR FREE EXCEL MITRE CUTTING CALCULATOR!*

● Option 1: External Corners

	Baluster Spacing	Cut Length
MIN	10mm	72mm
MAX	50mm	100mm

**CONTACT US FOR OUR FREE EXCEL MITRE CUTTING CALCULATOR!*

● Option 2: Internal Corners

VISOR™ FABRICATION – APPENDIX 4

DECK MOUNT BASE MITRED CORNERS

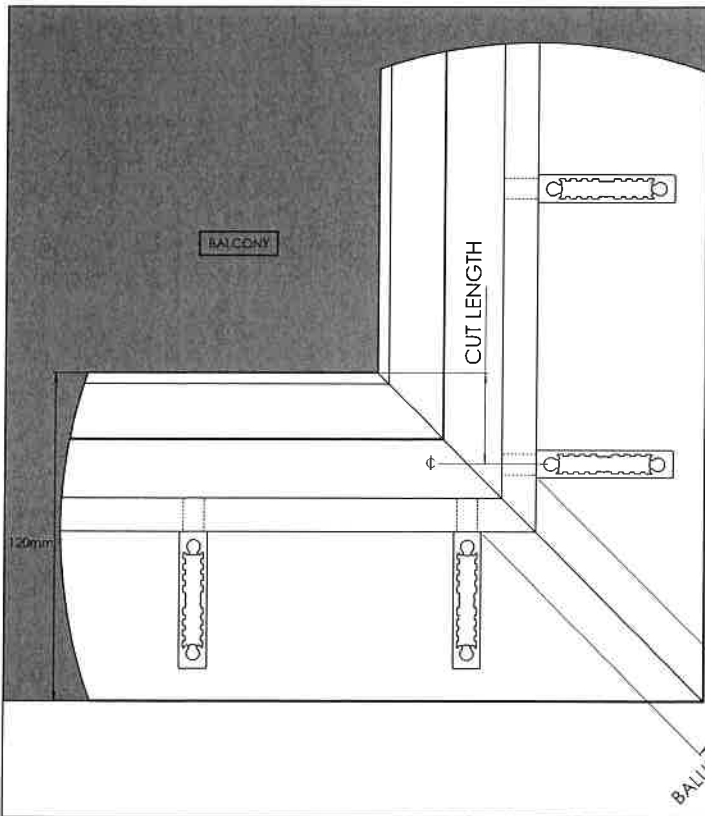

	Baluster Spacing	Cut Length
MIN	20mm	40mm
MAX	60mm	11mm

**CONTACT US FOR OUR FREE EXCEL MITRE CUTTING CALCULATOR!*

● Option 1: External Corners

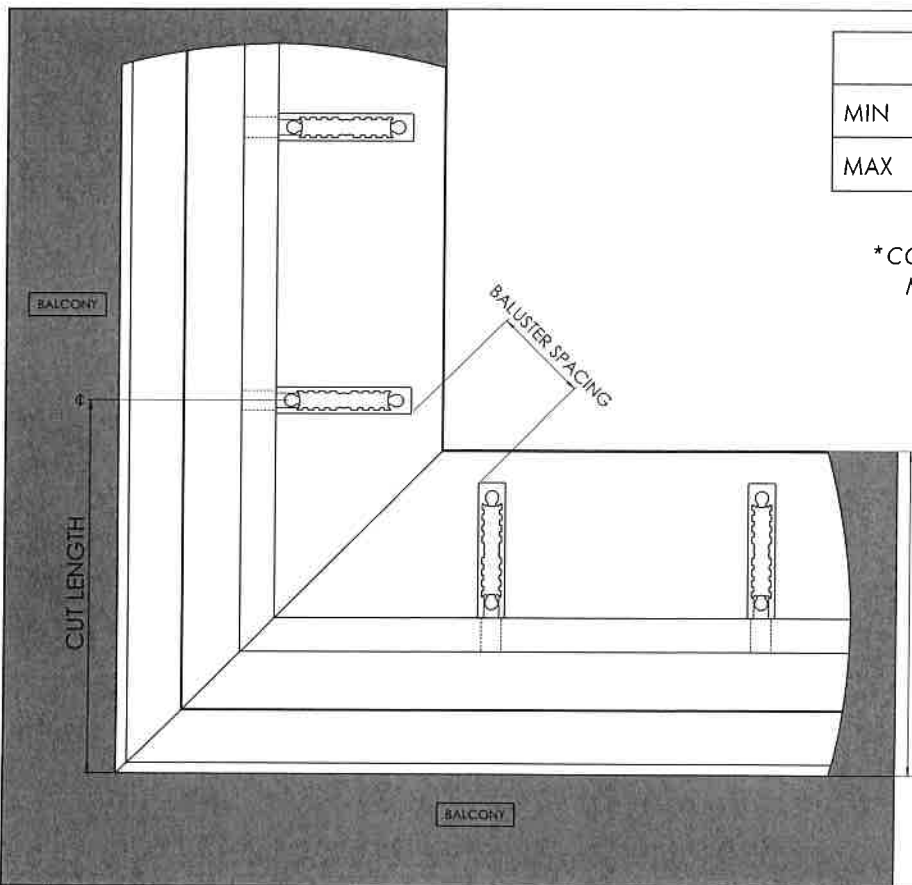

	Baluster Spacing	Cut Length
MIN	10mm	119mm
MAX	50mm	147mm

**CONTACT US FOR OUR FREE EXCEL MITRE CUTTING CALCULATOR!*

● Option 2: Internal Corners

VISOR™ FABRICATION – APPENDIX 5

DECK MOUNT BASE DRAINAGE CONSIDERATIONS

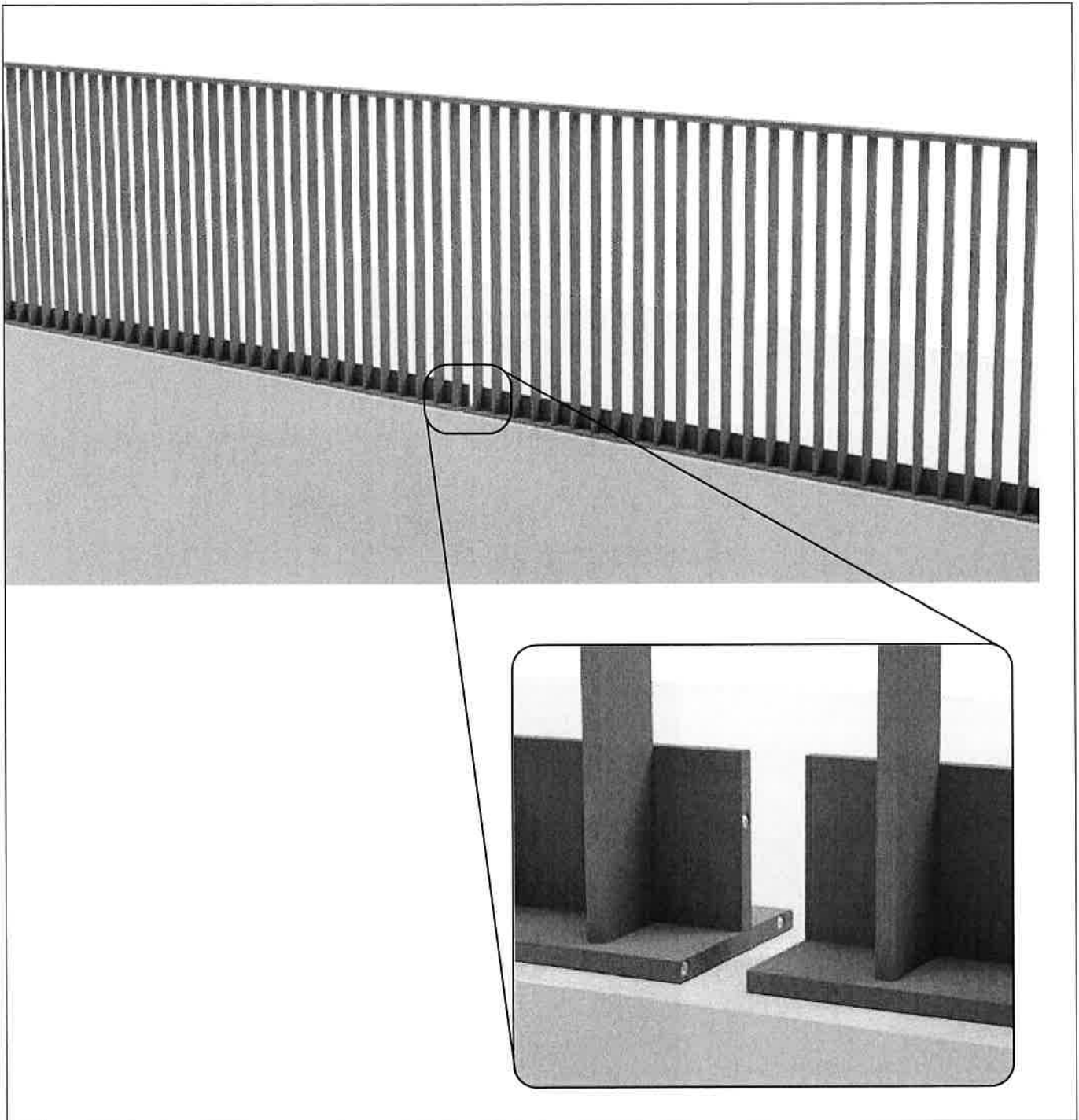

● For decks and balconies that require water drainage considerations, leave a 50mm gap in the Deck Mount Base, equally spaced between two Balusters.

Attach Deck Mount End Plates to each exposed base profile ends by drilling a 3.5mm hole and affixing with a colour matched 3.2mm Dia. aluminium pop rivet (not supplied).

Deck Mount Base fixtures to the substrate will be required on each side of this gap and the handrail will span this gap.

ALUMINIUM BALUSTRADE INNOVATION

Introduction

Glass Outlet's suite of aluminium systems sit at the intersection of style and innovation. Designed with labour saving technology in mind and non-weld assembly/installation, simply select post and handrail and then select between 5 infill styles.

All systems have engineer compliance certification. Contact us for details.

SAVE TIME AND
MONEY WITHOUT
COMPROMISE
ON QUALITY
OR STYLE.

01 STEP 1 / SELECT POST & HANDRAIL*

- (A) Core drill or base plate posts
- (B) Face mount posts
- (C) Oval or rectangular handrails* (*not required for Barr balustrade)

02 STEP 2 / SELECT INFILL

(same post & handrails used with all infills)

- (A) Barr balustrade
- (B) AIRE™ Square picket baluster (16.5x16.5mm)
- (C) AIRE™ Vertical slat balustrade (65x16.5mm)
- (D) Horizontal slat balustrade (65x16.5mm)
- (E) Premium Perforated sheet

03 STEP 3 / INSTALL

Enjoy the benefits of non-weld assembly with a superb finish.

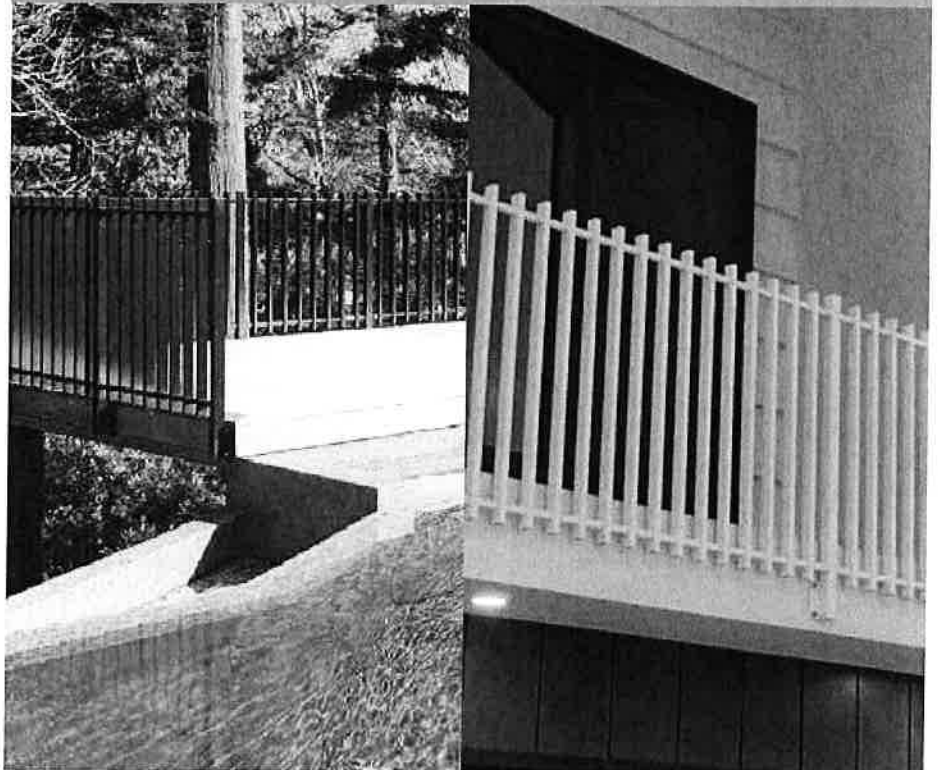

'MIX & MATCH' SYSTEMS

