

## HOW TO FASTEN EDGE CLIPS

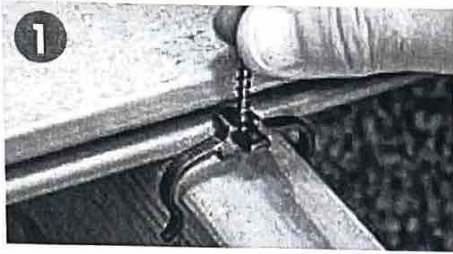

### 1 PLACE CLIP ON JOIST

Place a clip on the joist with the gusset in the groove. Clips stay in place until you're ready to fasten.



### 2 REPEAT ALONG THE BOARD

Place a clip at every joist along the length of the board.



### 3 SLIDE ON NEXT BOARD

Place the next board up against the clips, and repeat until you have multiple rows of boards and clips.

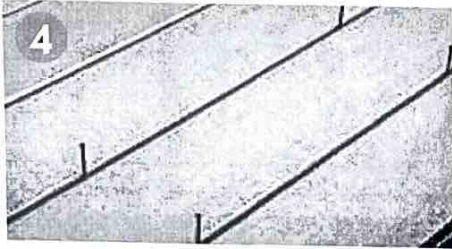

### 4 LOCK-IN YOUR BOARDS

Hold the boards tightly, or lock them in place with CAMO® LEVER®.

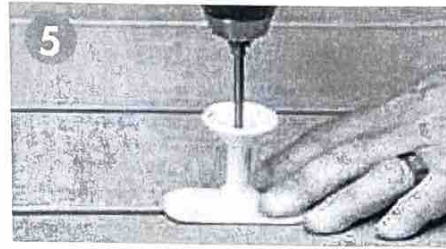

### 5 FASTEN WITH NEVER-MISS GUIDE

Starting at the outermost board, place the NEVER-MISS Guide (included) over the screw head, connect the bit to the head and drive. Repeat until all inner boards are fastened.

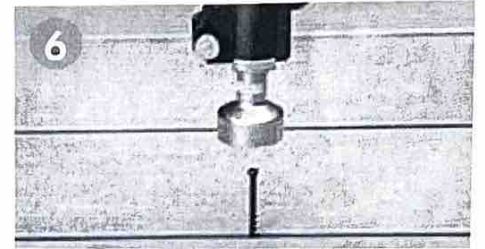

### 6 OR FASTEN WITH DRIVE (OPTIONAL)

To fasten with DRIVE, starting at the outermost board, put the Clip nose piece over the screw head and drive at full RPM while applying downward pressure. Repeat until all inner boards are fastened.

## HOW TO FASTEN EDGEX CLIPS



### 1 PLACE CLIP IN GROOVE

Pinch the wings of clip together and slide the clip into the groove. The wings of the clip will expand, holding the clip in place until you're ready to fasten.

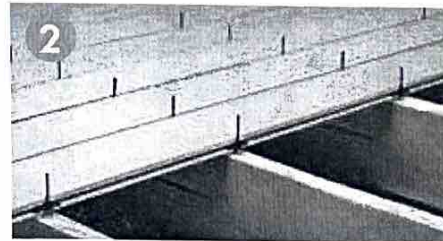

### 2 REPEAT ALONG THE BOARD

Place a clip at every joist along the length of the board.

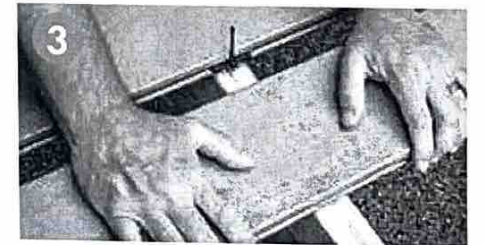

### 3 SLIDE ON NEXT BOARD

Place the next board up against the clips, and repeat until you have multiple rows of boards and clips.

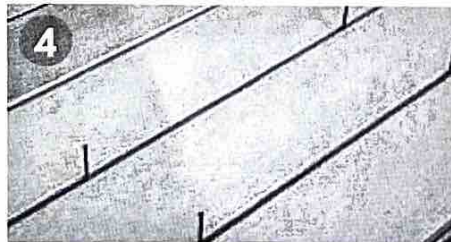

### 4 LOCK-IN YOUR BOARDS

Hold the boards tightly, or lock them in place with CAMO® LEVER®.



### 5 FASTEN WITH NEVER-MISS GUIDE

Starting at the outermost board, place the NEVER-MISS Guide (included) over the screw head, connect the bit to the head and drive. Repeat until all inner boards are fastened.

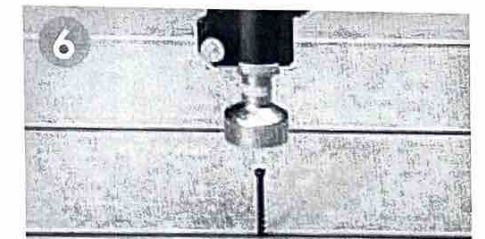

### 6 OR FASTEN WITH DRIVE (OPTIONAL)

To fasten with DRIVE, starting at the outermost board, put the Clip nose piece over the screw head and drive at full RPM while applying downward pressure. Repeat until all inner boards are fastened.



## HOW TO FASTEN EDGEXMETAL CLIPS

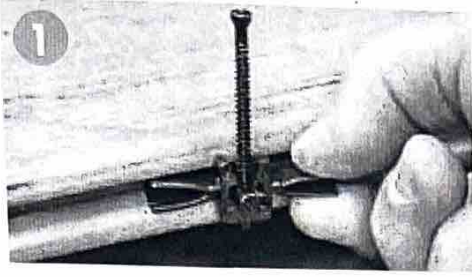

### 1 PLACE CLIP IN GROOVE

Pinch the wings of clip together and slide the clip into the groove. The wings of the clip will expand, holding the clip in place until you're ready to fasten.

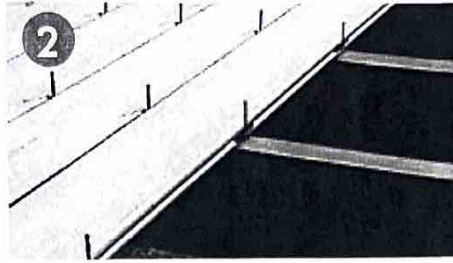

### 2 REPEAT ALONG THE BOARD

Place a clip at every joist along the length of the board.

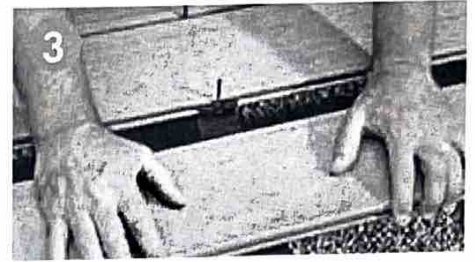

### 3 SLIDE ON NEXT BOARD

Place the next board up against the clips, and repeat until you have multiple rows of boards and clips.

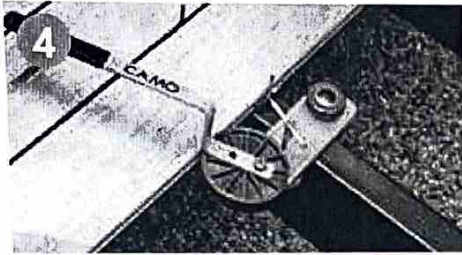

### 4 LOCK-IN YOUR BOARDS

Hold the boards tightly, or lock them in place with CAMO® LEVER®.

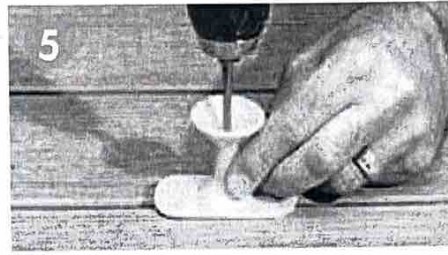

### 5 FASTEN WITH NEVER-MISS GUIDE

Starting at the outermost board, place the NEVER-MISS Guide (included) over the screw head, connect the bit to the head and drive. Repeat until all inner boards are fastened.

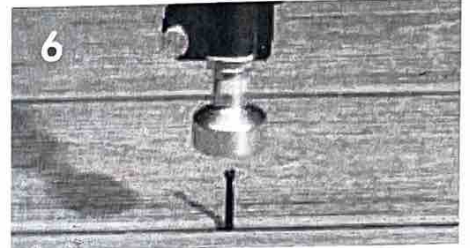

### 6 OR FASTEN WITH DRIVE (OPTIONAL)

To fasten with DRIVE, starting at the outermost board, put the Clip nose piece over the screw head and drive at full RPM while applying downward pressure. Repeat until all inner boards are fastened.

## HOW TO LOCK BOARDS WITH LEVER TOOL

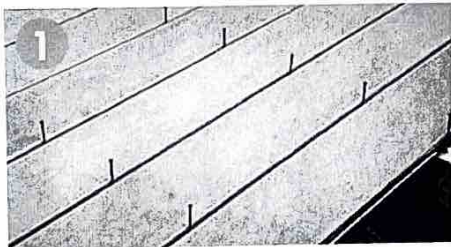

### 1 PREPARE BOARDS

Lay down multiple rows of boards and CAMO Universal Deck Clips.

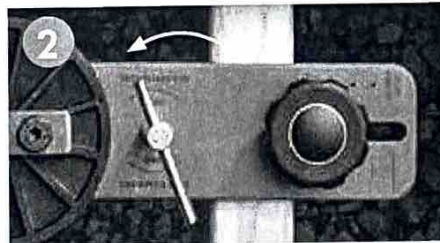

### 2 POSITION

Place LEVER on the joist and tighten the joist cam with the pivot pin.

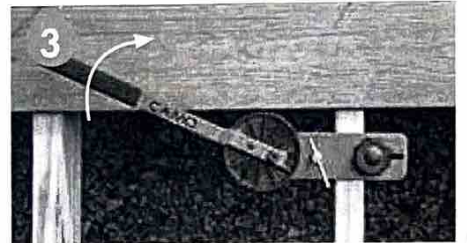

### 3 LOCK-IN

Apply pressure by moving the handle towards the deck board. Do not overtighten as the boards can buckle.

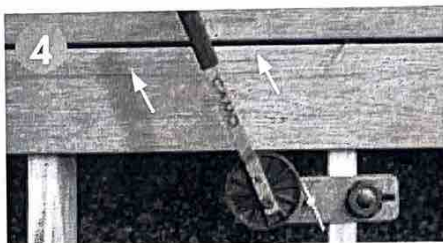

### 4 FASTEN

Leave LEVER in place until all clips are fastened.

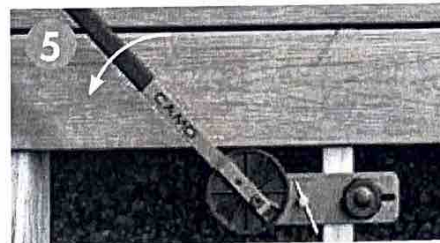

### 5 RELEASE

Release pressure by moving the handle away from the deck board.

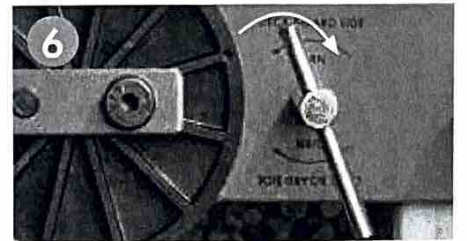

### 6 REMOVE

Loosen the joist cam and remove LEVER.



# HOW TO FASTEN WITH CLIPDRIVE

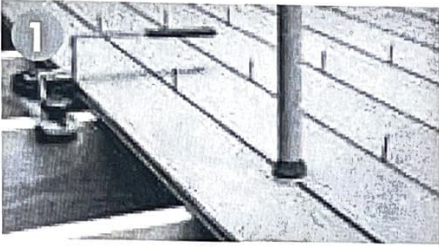

**POSITION NOSE OVER CLIP**  
Starting at the outermost board, place the nose over the exposed screw.



**ENGAGE DRILL**  
With the nose flat on the surface of the board, and pressure on the handle, run the drill at full speed, and push the driver drill down to engage the bit and screw.



**FASTEN THE BOARD**  
Apply steady pressure and continue to drive until the drill clutch releases.

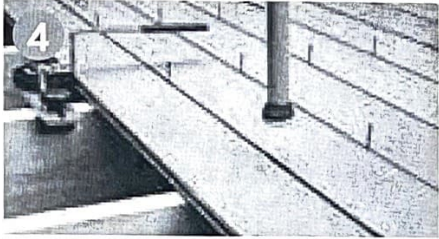

**LIFT UP TOOL**  
After fastening, lift up on the tool to return your drill to starting position.

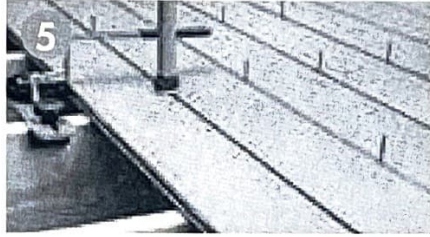

**FASTEN EVERY JOIST**  
Fasten all of the remaining clips at each joist.

